

# STARMAX



**MR** MARINE AND RV  
AGM TECHNOLOGY  
**BATTERIES**

LONG LASTING . DURABLE . RELIABLE



[www.starmaxbatteries.com](http://www.starmaxbatteries.com)

# STM 12 - 210M AGM

## Dimensions (mm)

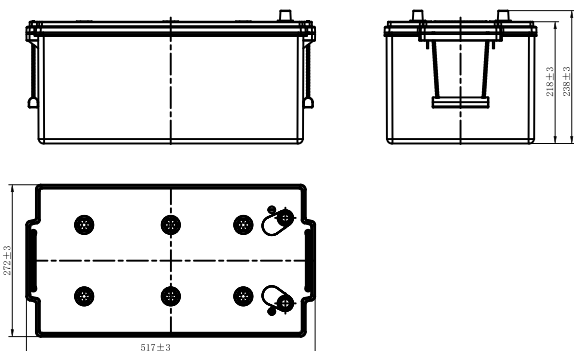

## General Features

- Superior starting & cycling performance
- Spill-proof, maintenance free AGM technology
- 3x higher cycle life compared to conventional starter batteries
- 2x Faster Charge Acceptance compared to conventional strater batteries
- High Strength Absorbed Glass Mat (AGM) Seperator built to withstand vibration
- Leak proof, double sealed lid for tilt protection
- UL recognized, IEC60896-21 & 22 certified and IATA approved for air freight

## Electrical Specifications

Rated Capacity	20 hour rate(10.5A)	210Ah
Reserve Capacity		450min
Cold Cranking Performance Amps@0°F(-18°C)		1200A



## Physical Specifications (mm)

Nominal Voltage	12V	
Nominal Capacity(20HR)	210Ah	
Dimension	Length	517±3mm(20.35inches)
	Width	272±3mm(10.71inches)
	Container Height	218±3mm(8.58inches)
	Total Height (with Terminal)	238±3mm(9.37inches)
Weight	Approx 62Kg(136.7lbs)	
Standard Terminal	5	
Cell layout	3	
Hold-Down	B0	
Cell plate qty	/	
Case	Black-PP Material	
Cover	Black-PP Material	
Handle	Black-PP Material	

### Standard Terminal (mm)

### Cell Layout

Terminal  
Type

5

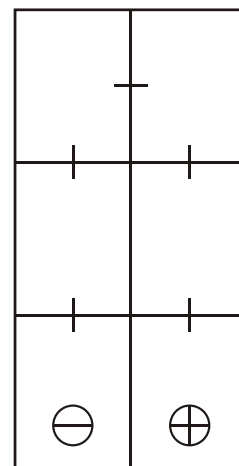
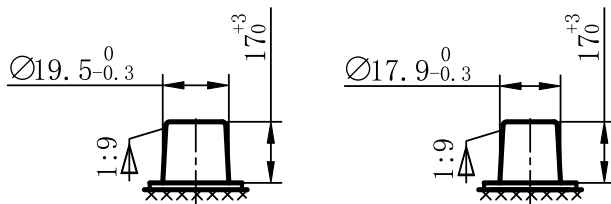

Figure(4)

## Discharge Characteristics(-18°C,0°F)

STM12-210M  
(CCA-EN)Capacity Test(@-18)with I=1200A  
Spec  $U_{10s} \geq 7.5V$   $t_{6v} \geq 90s$

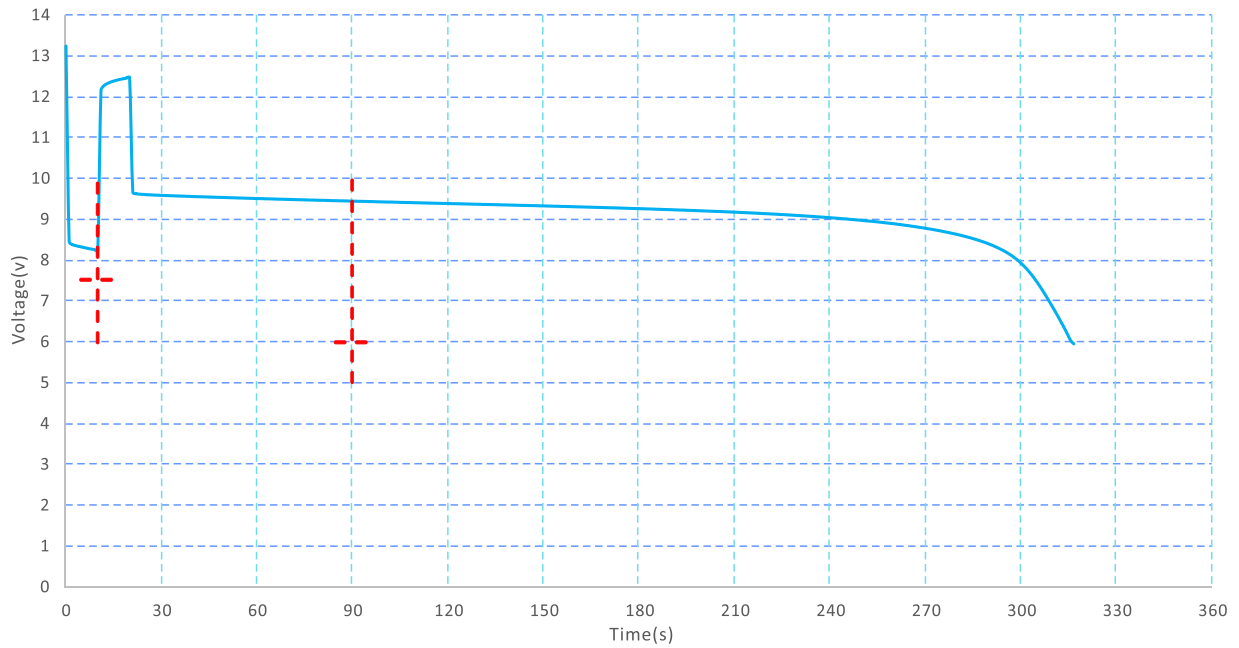

\*Values are subject to variation of +/- 5% in normal manufacturing processes.

\*Technical specifications and the product line above could be changed without prior notice.



**Starmax Corporation**

1585 Cliveden Avenue, Delta, British Columbia  
V3M 6M1, Canada

**Phone:** +1 888 669 1310

**Email:** [info@starmaxbatteries.com](mailto:info@starmaxbatteries.com)

**Website:** [www.starmaxbatteries.com](http://www.starmaxbatteries.com)

