

STARMAX



MR MARINE AND RV
DEEP CYCLE AGM
BATTERIES
LONG LASTING . DURABLE . RELIABLE



www.starmaxbatteries.com

STM 12 - 180 HD DEEP CYCLE AGM

Dimensions (mm)

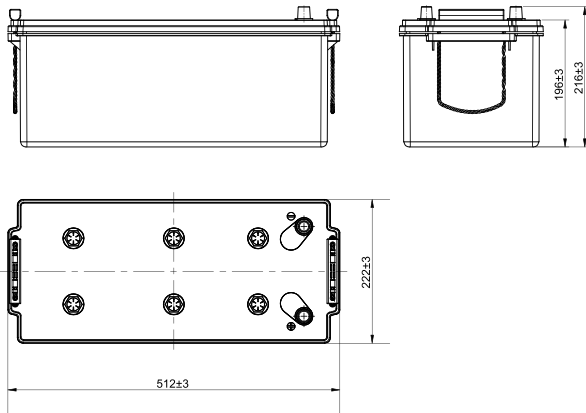

General Features

- Remote locations
- Limited accessibility
- When time & convenience is valued
- Where flooded batteries are failing prematurely due to improper care
- Batteries will operate after pre-sale equipment storage or off-season storage
- Can withstand rough terrain Cold environments– less likely to freeze
- Can be used near people and sensitive equipment Regulation compliance: schools, hospitals, airports, etc
- Space-restricted installations
- Regulation compliance: schools, hospitals, airports, etc

Deep Cycle Design for High Capacity and Maximum Life

- Paste customized for deep cycle performance; paste formula, process and ratio of positive to negative active materials.
- Unique production process used to maximize cycle life.
- Paste formula designed to minimize water consumption providing longer service life.



Superior Performance in Wide Variety of Applications

- Special mixture of carbon and other proprietary additives in negative active material to perform in partial state of charge (PSoC) applications and to increase charge acceptance for optimized charging and fast charging capability.

One-of-a-Kind AGM Separator

- Starmax manufactures its own AGM separator, unlike any in the market, to lower internal resistance, keep plates wet, maintain cell compression and prevent acid stratification (one of the leading causes of failure in AGM batteries).
Double wrapping to prevent the short circuit and acid stratification

Hybrid Gel Technology

- Exclusive formula of highly refined silica added to reduce acid stratification
Further extends the service life of the battery

Electrical Specifications

Rated Capacity	20 hour rate(9.0A)	180Ah
Reserve Capacity		380min
Cold Cranking Performance Amps@0°F(-18°C)		900A

Physical Specifications (mm)

Nominal Voltage		12V
Nominal Capacity(20HR)		180Ah
Dimension	Length	512±3mm(20.16inches)
	Width	222±3mm(8.74inches)
	Container Height	196±3mm(7.72inches)
	Total Height (with Terminal)	216±3mm(8.50inches)
Weight		Approx 50.5Kg(111.4lbs)
Standard Terminal		5
Cell layout		3
Hold-Down		B0
Cell plate qty		/
Case		Black-PP Material
Cover		Black-PP Material
Handle		Black-PP Material

Standard Terminal (mm)

Cell Layout

Terminal Type

5

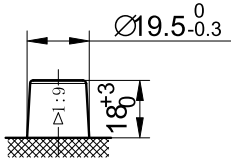

POS

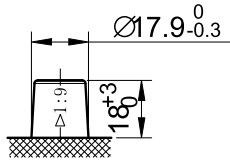

NEG

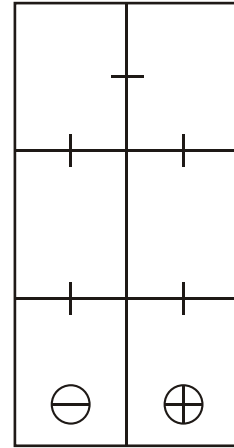

Figure(3)

Discharge Characteristics(-18°C,0°F)

STM12-180HD (CCA-EN)
 (CCA-SAE)Capacity Test(@-18)with I=900A
 Spec $U_{10s} \geq 7.5V$ $U_{30s} \geq 7.2V$

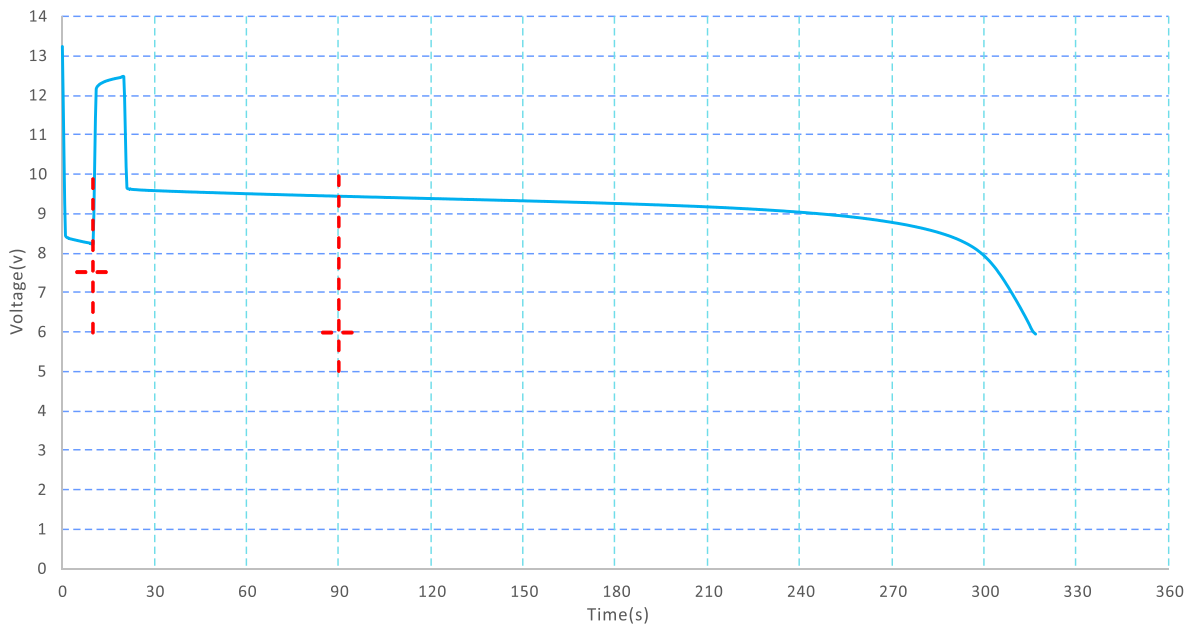

*Values are subject to variation of +/- 5% in normal manufacturing processes.

*Technical specifications and the product line above could be changed without prior notice.



Starmax Corporation

1585 Cliveden Avenue, Delta, British Columbia
V3M 6M1, Canada

Phone: +1 888 669 1310

Email: info@starmaxbatteries.com

Website: www.starmaxbatteries.com

