

# STARMAX

The world's leading battery brand



## HRL SERIES-LONG LIFE **BATTERIES**

HRL 12120W



[www.starmaxbatteries.com](http://www.starmaxbatteries.com)

# HRL Series

## HRL 12120W

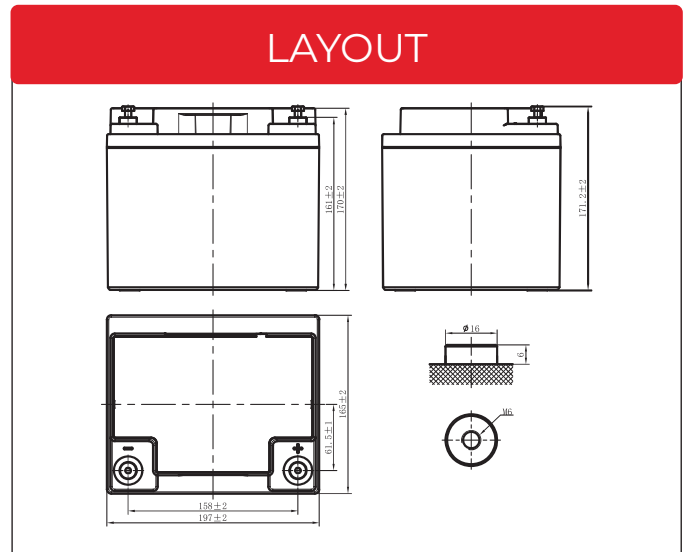

## General Features

- ✓ **High quality AGM separator:** Extend cycle life and prevent micro short circuit
- ✓ **PbCaSn alloy for plate grids:** Less gassing, less self-discharging
- ✓ **Unique vent valve design:** Reduce water losing and prevent air/spark going inside

## Applications

- ✓ UPS
- ✓ Hospitals & Testing Laboratories
- ✓ Emergency Power Supply
- ✓ Industrial Process Control Facilities
- ✓ Banks & Financial Markets
- ✓ Data & Network Operation Centers

## Standards

- ✓ Compliance with IEC 60896 standards
- ✓ Classified as "General Purpose" according to Eurobat
- ✓ CE, UL, IEC Cer tified
- ✓ Manufactured in Starmax, ISO 45001, ISO 9001 and ISO 14001 certified production facilities



# SPECIFICATIONS

Rated Voltage	12V		
Nominal Rate	(W <sub>15</sub> ,1.67V/cell)	120W	
Nominal Capacity	(C <sub>10</sub> ,1.80V/cell)	38Ah	
Dimensions	Length	197±2mm (7.76 inches)	
	Width	165±2mm (6.50 inches)	
	Container height	170±2mm (6.69 inches)	
	Total height	170±2mm (6.69 inches)	
Approx. weight	11.6 Kg (25.57 lbs)		
Terminal	M6		
Container material	ABS: UL 94 HB or V-0		
Rated capacity (25°C)	38.0 Ah	(10hr, 3.80A,1.80V/cell)	
	35.3 Ah	(8hr, 4.41A,1.80V/cell)	
	33.5 Ah	(5hr, 6.69A,1.75V/cell)	
	24.5 Ah	(3hr, 10.1A,1.75V/cell)	
	24.5 Ah	(1hr, 24.5A,1.67V/cell)	
Max. discharge current	500A		
Internal resistance (25°C)	Approx. 10.0mΩ		
Operating temp. range	Discharge	-20~55°C (4~131°F)	
	Charge	-20~40°C (-4~104°F)	
	Storage	-15~50°C (5~122°F)	
Nominal operating temp. range	25±3°C (77±5°F)		
Max.Charging Current(25°C)	9.5A		
Charge voltage(25°C)	<b>Charge voltage</b>		<b>Temp. Coefficient</b>
	Float	2.25~2.30V/cell	-3mV/cell/°C
	Equalization	2.30~2.40V/cell	-4mV/cell/°C
Effect of temp. to Capacity	40°C (104°F)		106%
	25°C (77°F)		100%
	0°C (32°F)		86%
Self discharge	≤3%/month @ 25°C		

## Constant Current Discharge (Amperes) at 25°C (77°F)

F.V/Time	5min	10min	15min	20min	30min	45min	1h	1.5h	2h	3h	4h	5h	8h	10h
1.85V/cell	71.8	57.3	49.7	39.1	27.6	26.8	21.0	15.6	12.6	9.35	7.40	6.26	4.32	3.70
1.80V/cell	81.6	65.1	56.3	44.2	31.1	28.4	22.4	16.6	13.3	9.79	7.67	6.50	4.41	3.80
1.75V/cell	88.7	70.6	61.0	47.7	33.4	29.6	23.3	17.2	13.8	10.1	7.92	6.69	4.46	3.82
1.70V/cell	94.8	75.2	64.7	50.6	35.4	30.5	23.9	17.7	14.1	10.3	8.12	6.84	4.53	3.84
1.67V/cell	98.1	77.6	66.6	52.0	36.3	31.3	24.5	18.1	14.5	10.6	8.22	6.93	4.58	3.90
1.60V/cell	101.6	80.3	68.7	53.3	37.2	31.9	24.9	18.5	14.8	10.8	8.41	7.07	4.60	3.92

## Constant Power Discharge (Watts/cell) at 25°C (77°F)

F.V/Time	5min	10min	15min	20min	30min	45min	1h	1.5h	2h	3h	4h	5h	8h	10h
1.85V/cell	134.1	107.8	94.1	74.3	52.7	51.6	40.7	30.3	24.4	18.3	14.5	12.3	8.58	7.35
1.80V/cell	150.0	120.6	105.2	83.1	58.9	54.3	43.0	32.0	25.7	19.0	15.0	12.8	8.73	7.55
1.75V/cell	160.1	128.7	112.3	88.7	62.9	56.1	44.6	33.1	26.6	19.6	15.4	13.1	8.80	7.57
1.70V/cell	168.3	135.3	118.1	93.3	66.1	57.5	45.5	33.8	27.1	20.0	15.7	13.3	8.92	7.61
1.67V/cell	171.0	137.5	120.0	94.8	67.2	58.7	46.4	34.4	27.7	20.3	15.9	13.5	9.00	7.72
1.60V/cell	173.4	139.4	121.7	96.1	68.1	59.2	46.9	34.8	28.0	20.7	16.2	13.7	9.03	7.75

## Discharge Characteristics

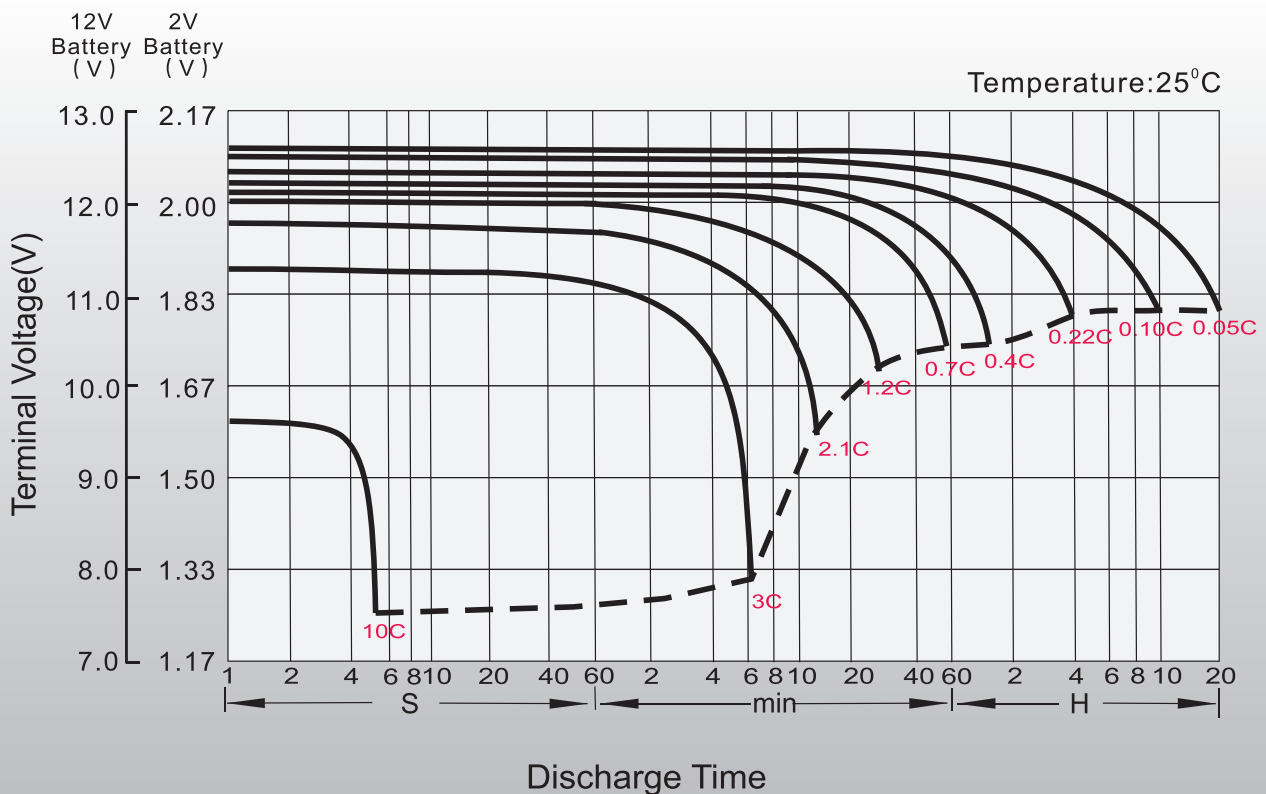

# Float Charging Characteristics

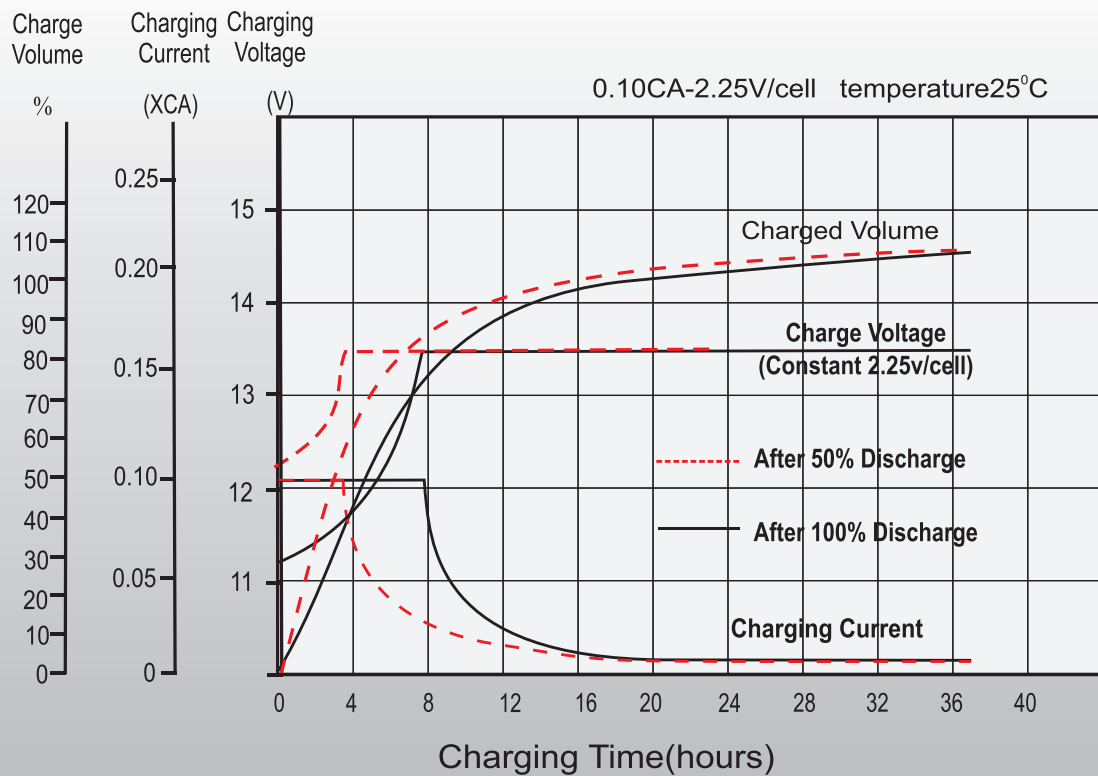

# Temperature Effects in Relation to Battery Capacity

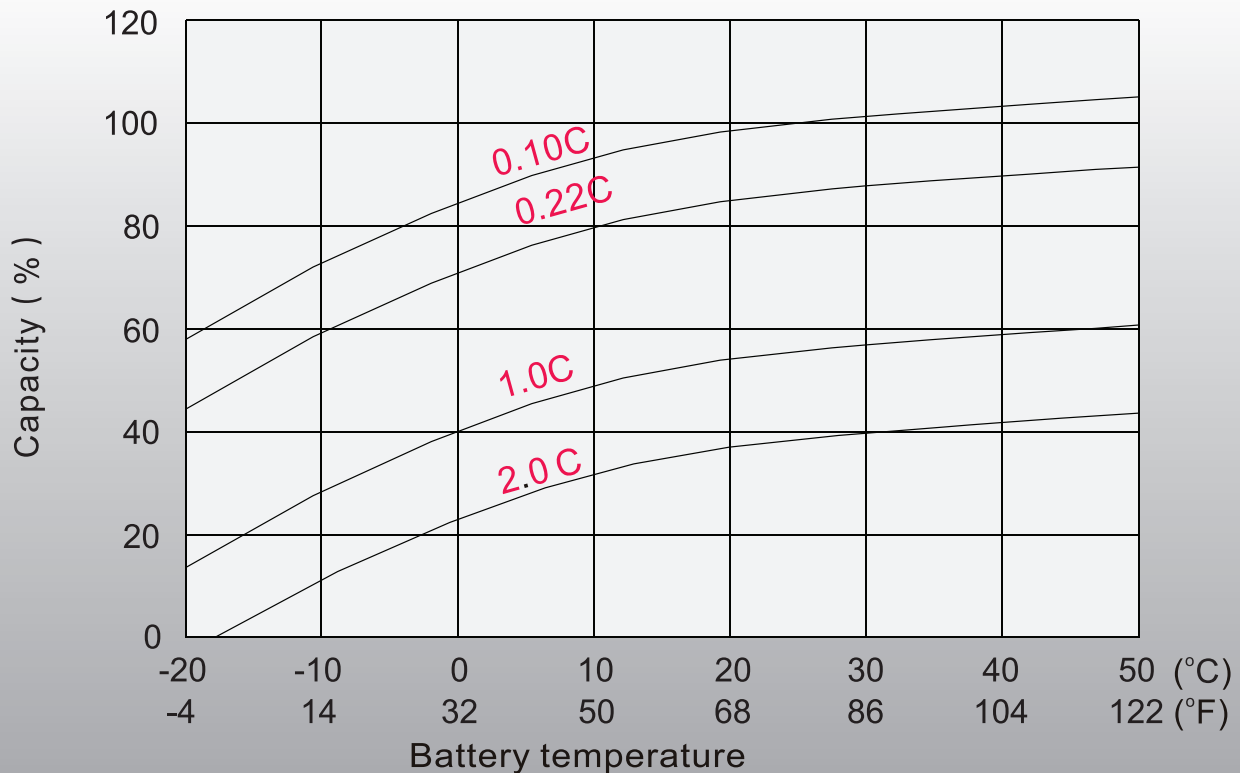



# Effect of Temperature on Long Time Float Life

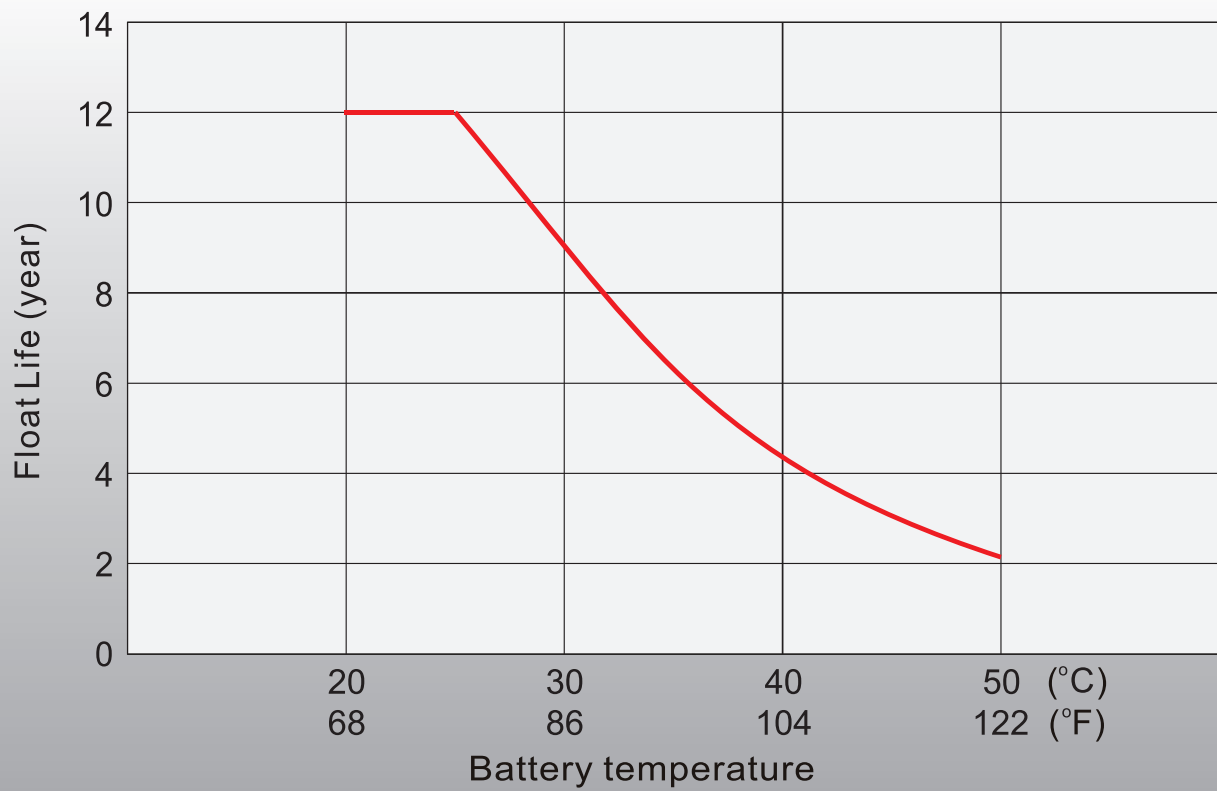



**Starmax Corporation**

1585 Cliveden Avenue, Delta, British Columbia  
V3M 6M1, Canada

**Phone:** +1 888 669 1310

**Email:** [info@starmaxbatteries.com](mailto:info@starmaxbatteries.com)

**Website:** [www.starmaxbatteries.com](http://www.starmaxbatteries.com)

