



The world's leading battery brand



HR SERIES-HIGH RATE **BATTERIES**

HR 12500W



www.starmaxbatteries.com

HR 12500W



SPECIFICATIONS

Nominal Voltage	12V	
Number of Cell	6 cells	
Rated Capacity (15min. rat)	500 Watts/cell	
Dimensions	Length	342±2mm(13.46inch)
	Width	172±2mm(6.77inch)
	Height	280±2mm(11.02inch)
	Total Height	285±2mm(11.2inch)
Approx. Weight	44kg (97.0lbs)±3%	

CHARACTERISTICS

Capacity (20HR, 25°C)	140Ah	
Capacity (15min.rate, 25°C)	500 Watts/cell	
Terminal Type	T14	
Internal Resistance (Fully Charged, 25°C)	Approx. 3.8mΩ	
Capacity Affected by Temperature (10HR)	40°C	102%
	25°C	100%
	0°C	85%
	-15°C	65%
Self-Discharge (25°C)	3 months	Remaining Capacity: 91%
	6 months	Remaining Capacity: 82%
	12months	Remaining Capacity: 65%
Nominal Operating Temperature	25±3°C (77±5°F)	
Operating Temperature Range	Discharge	-15°C~50°C(5°F~122°F)
	Charge	-10°C~50°C(14°F~122°F)
	Storage	-20°C~50°C(4°F~122°F)
Float Charging Voltage (25°C)	13.50 to 13.80V Temperature Compensation: -18mV/°C	
Cyclic Charging Voltage (25°C)	14.50 to 15.00V Temperature Compensation: -30mV/°C	
Maximum Charging Current	42A	
Terminal Material	Copper	
Maximum Discharge Current	1050A(5 sec)	
Design Floating Life(20°C)	10 Years	

Outer Dimensions (mm)

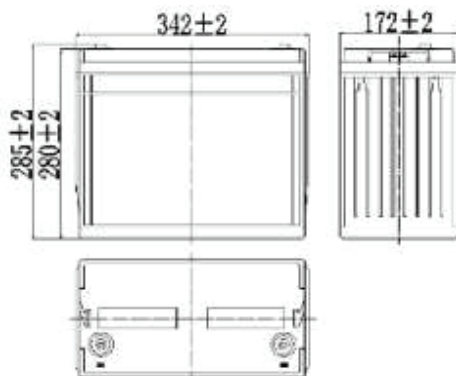

Terminal Type (mm)

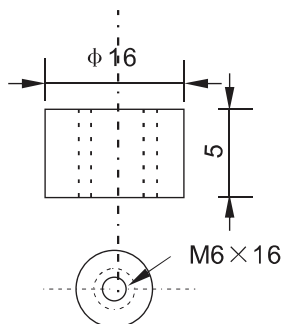

T16A

Discharge Characteristics

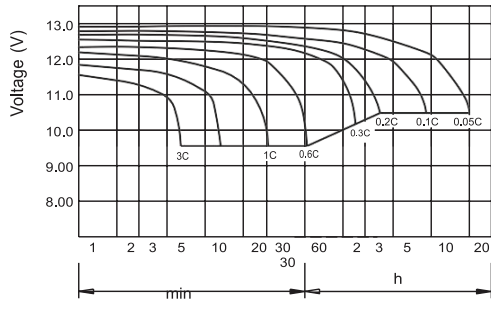

Charging Characteristics (25°C)

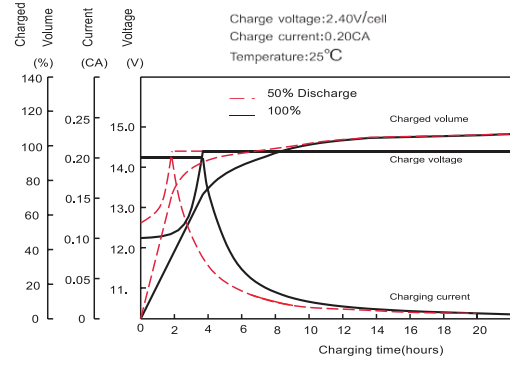

Effect of Temp on Capacity

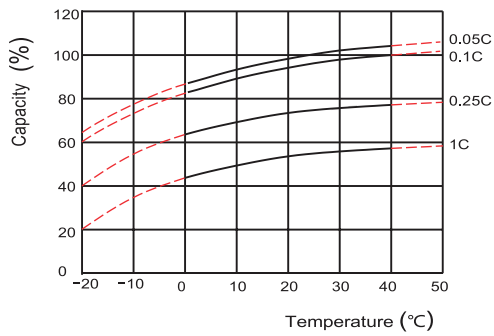

Self-Discharge Characteristics

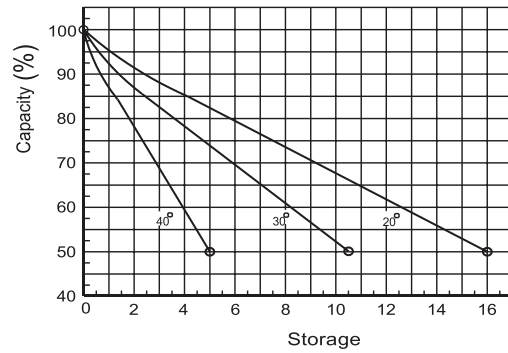

Floating Life on Temperature

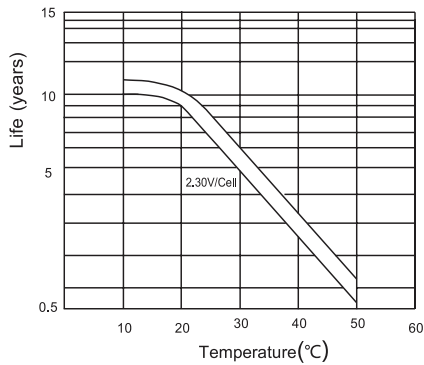

Cycle Service Life on D.O.D (25°C)

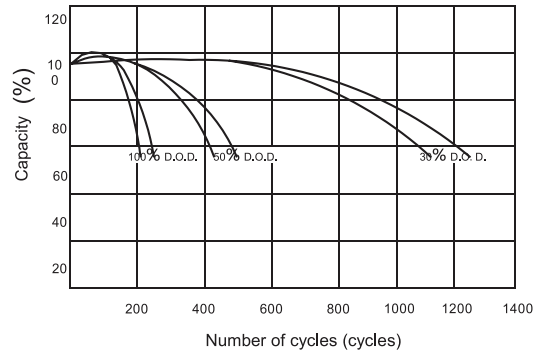

Relationship for OCV and Capacity (25°C)

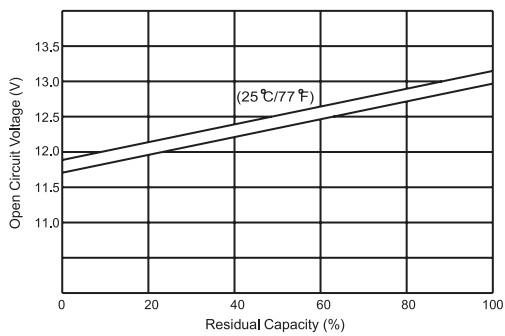

Relationship for Charging Voltage/cell and Temp

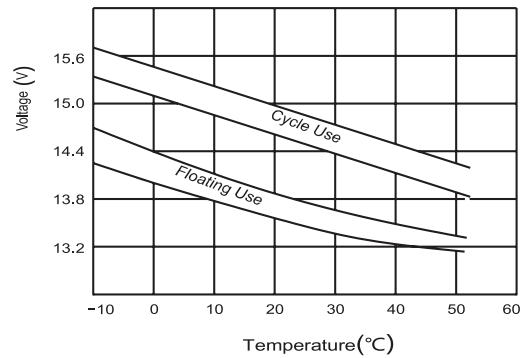

Construction

Component	Positive Plate	Negative Plate	Container	Cover	Separator	Electrolyte	Safety Valve	Terminal
Raw material	Lead Dioxide	Lead	ABS	ABS	AGM	Sulfuric Acid	Rubber	Copper

Constant Current Discharge Characteristics Unit: A(25°C, 77°F)

F.V/Time	10min	15min	20min	30min	45min	60min	2h	3h	4h	5h	6h
1.60V/cell	328.6	269.2	215.2	152.6	113.4	92.8	53.1	38.1	30.6	26.7	22.8
1.67V/cell	313.8	260.8	206.7	147.3	110.2	90.4	52.6	37.7	30.4	26.4	22.6
1.70V/cell	302.1	253.3	202.5	145.2	108.1	89.1	52.6	37.6	30.3	26.3	22.5
1.75V/cell	292.6	244.9	196.1	141	105.4	87.2	51.5	37.3	30.1	26.2	22.4
1.80V/cell	276.7	231.1	185.5	136.7	101.6	84.6	50.1	36.3	29.2	25.3	21.8

Constant Power Discharge Characteristics Unit: W(25°C, 77°F)

F.V/Time	10min	15min	20min	30min	45min	60min	2h	3h	4h	5h	6h
1.60V/cell	619.1	519.4	415.5	294.7	219.4	179.1	103.5	74.9	60.4	52.8	45.2
1.67V/cell	590.4	504.6	398.6	285.1	212	174.9	102.6	74.3	59.9	52.4	44.7
1.70V/cell	575.6	488.7	391.1	279.8	208.8	171.7	102	74	59.7	52.2	44.6
1.75V/cell	550.1	471.7	377.4	273.5	203.5	168.5	100.4	73.6	59.3	51.7	44.3
1.80V/cell	519.4	447.3	357.2	262.9	196.1	163.2	97.8	71.3	57.5	50.2	42.9



Starmax Corporation

1585 Cliveden Avenue, Delta, British Columbia
V3M 6M1, Canada

Phone: +1 888 669 1310

Email: info@starmaxbatteries.com

Website: www.starmaxbatteries.com

