

STARMAX

The world's leading battery brand



HR SERIES-HIGH RATE **BATTERIES**

HR 12475W



www.starmaxbatteries.com

HR 12475W



SPECIFICATIONS

Nominal Voltage	12V	
Number of Cell	6 cells	
Rated Capacity (15min. rat)	475 Watts/cell	
Dimensions	Length	345±2mm(13.46inch)
	Width	172±2mm(6.77inch)
	Height	280±2mm(11.02inch)
	Total Height	285±2mm(11.2inch)
Approx. Weight	42kg (92.4lbs)±3%	

CHARACTERISTICS

Capacity (20HR, 25°C)	134Ah	
Capacity (15min.rate, 25°C)	475 Watts/cell	
Terminal Type	T14	
Internal Resistance (Fully Charged, 25°C)	Approx. 3.8mΩ	
Capacity Affected by Temperature (10HR)	40°C	102%
	25°C	100%
	0°C	85%
	-15°C	65%
Self-Discharge (25°C)	3 months	Remaining Capacity: 91%
	6 months	Remaining Capacity: 82%
	12months	Remaining Capacity: 65%
Nominal Operating Temperature	25±3°C (77±5°F)	
Operating Temperature Range	Discharge	-15°C~50°C(5°F~122°F)
	Charge	-10°C~50°C(14°F~122°F)
	Storage	-20°C~50°C(4°F~122°F)
Float Charging Voltage (25°C)	13.50 to 13.80V Temperature Compensation: -18mV/°C	
Cyclic Charging Voltage (25°C)	14.50 to 15.00V Temperature Compensation: -30mV/°C	
Maximum Charging Current	40.2A	
Terminal Material	Copper	
Maximum Discharge Current	1050A(5 sec)	
Design Floating Life(20°C)	10 Years	

Outer Dimensions (mm)

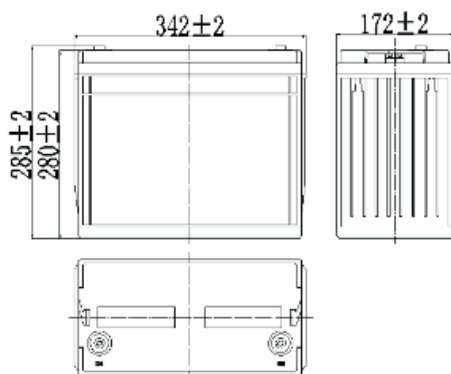

Terminal Type (mm)

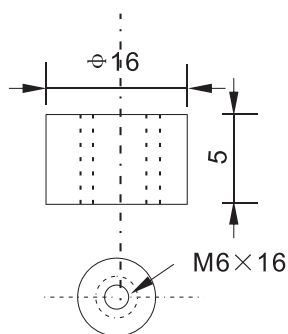

Discharge Characteristics

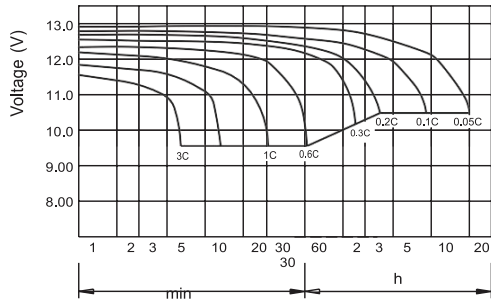

Charging Characteristics (25°C)

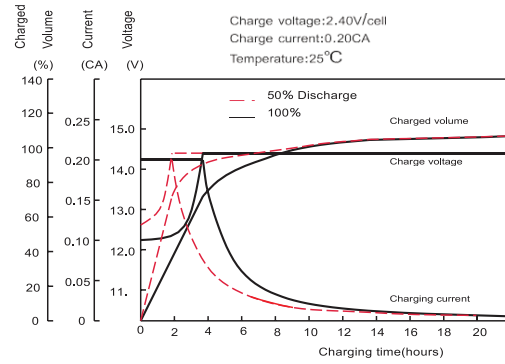

Effect of Temp on Capacity

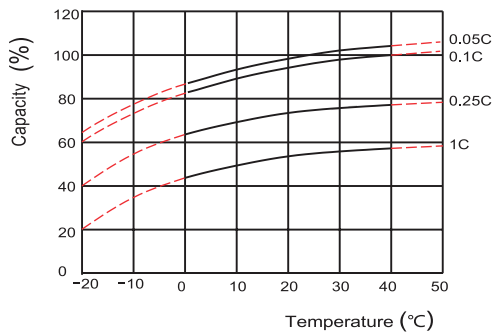

Self-Discharge Characteristics

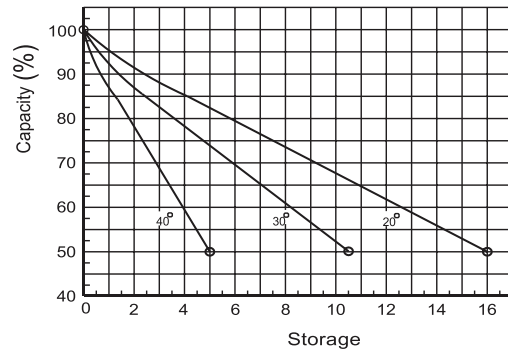

Floating Life on Temperature

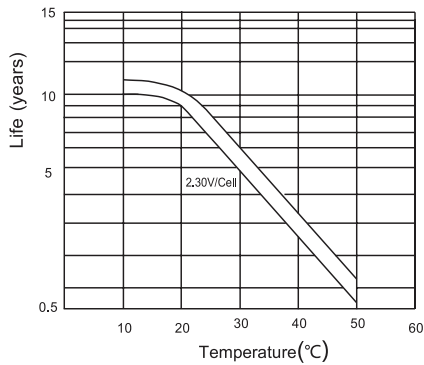

Cycle Service Life on D.O.D (25°C)

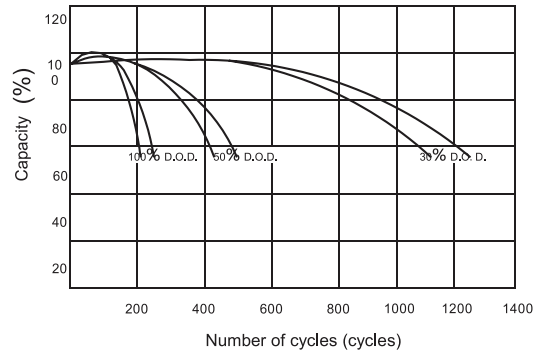

Relationship for OCV and Capacity (25°C)

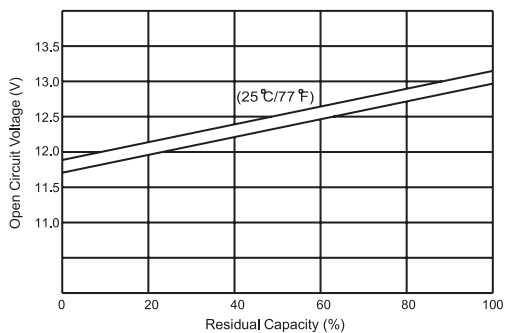

Relationship for Charging Voltage and Temp

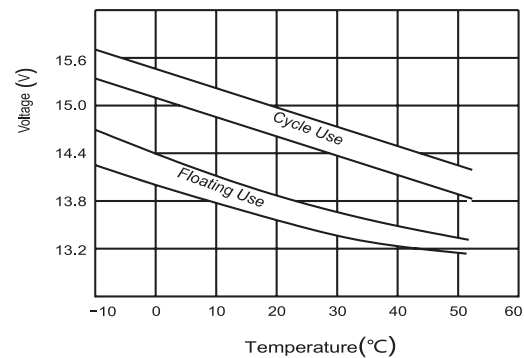

Construction

Component	Positive Plate	Negative Plate	Container	Cover	Separator	Electrolyte	Safety Valve	Terminal
Raw material	Lead Dioxide	Lead	ABS	ABS	AGM	Sulfuric Acid	Rubber	Copper

Constant Current Discharge Characteristics Unit: A(25°C, 77°F)

F.V/Time	10min	15min	20min	30min	45min	60min	2h	3h	4h	5h	6h
1.60V/cell	310	254	203	144	107	87.5	50.1	35.9	28.9	25.2	21.5
1.67V/cell	296	246	195	139	104	85.3	49.6	35.6	28.7	24.9	21.3
1.70V/cell	285	239	191	137	102	84.0	49.3	35.5	28.6	24.8	21.2
1.75V/cell	276	231	185	133	99.4	82.3	48.6	35.2	28.4	24.7	21.1
1.80V/cell	261	218	175	129	95.8	79.8	47.3	34.2	27.5	23.9	20.5

Constant Power Discharge Characteristics Unit: W(25°C, 77°F)

F.V/Time	10min	15min	20min	30min	45min	60min	2h	3h	4h	5h	6h
1.60V/cell	584	490	392	278	207	169	97.6	70.7	57.0	49.8	42.6
1.67V/cell	557	476	376	269	200	165	96.8	70.1	56.5	49.4	42.2
1.70V/cell	543	461	369	264	197	162	96.2	69.8	56.3	49.2	42.1
1.75V/cell	519	445	356	258	192	159	94.7	69.4	55.9	48.8	41.8
1.80V/cell	490	422	337	248	185	154	92.3	67.3	54.2	47.4	40.5



Starmax Corporation

1585 Cliveden Avenue, Delta, British Columbia
V3M 6M1, Canada

Phone: +1 888 669 1310

Email: info@starmaxbatteries.com

Website: www.starmaxbatteries.com

